

20' CONTOURS

CITY OF
WINONA, MINNESOTA

MAX CONRAD FIELD

AIR SPACE OBSTRUCTION ZONES

ROBERT J. BOLLANT		CITY ENGINEER
DRAWN BY - J.E.C.	SCALE - 1" = 5000'	FILE NO. - H-99.0
TRACED BY -	MARCH 13, 1974	JOB NO. - 7401

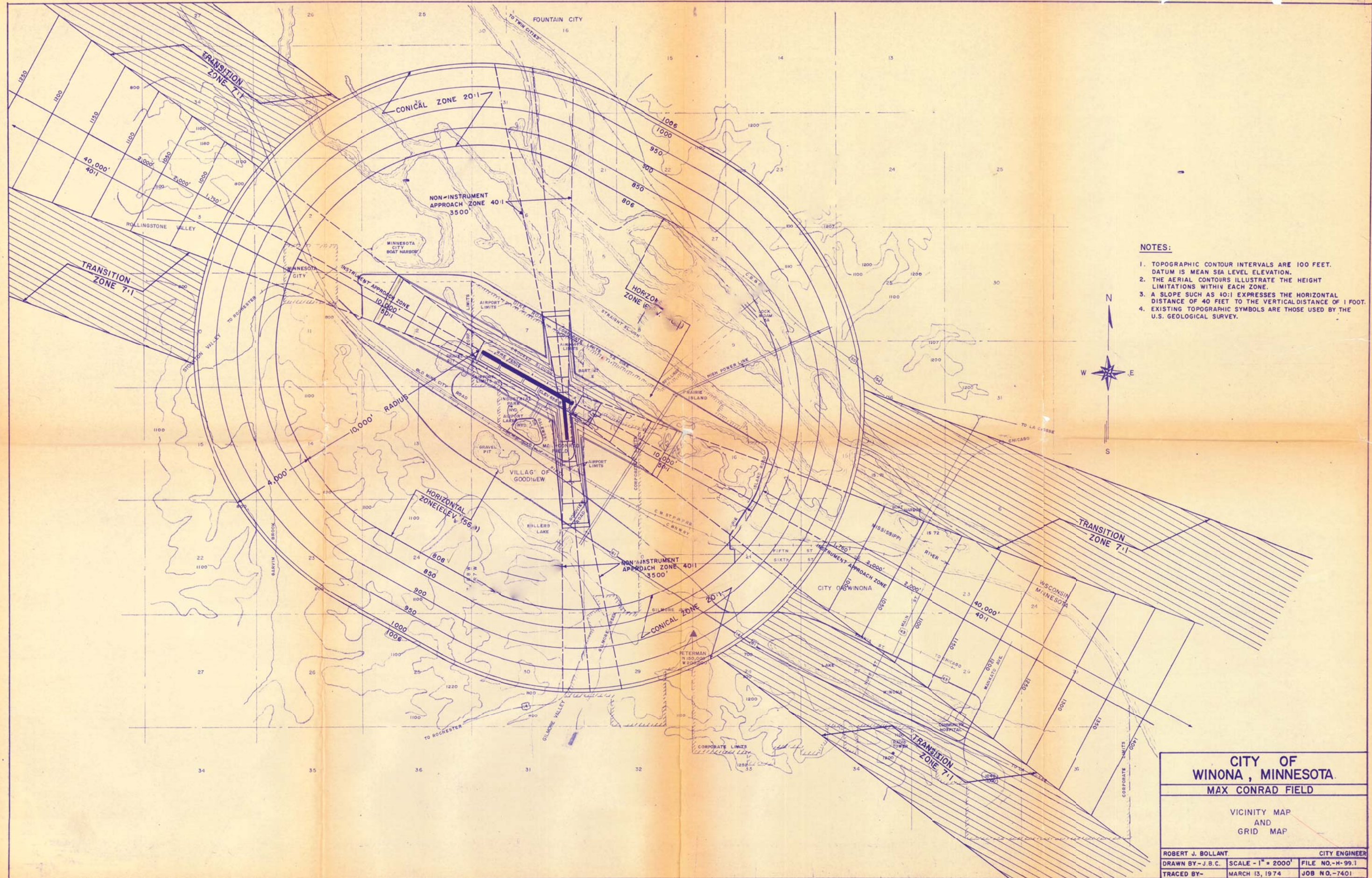

- NOTES:**
1. TOPOGRAPHIC CONTOUR INTERVALS ARE 100 FEET. DATUM IS MEAN SEA LEVEL ELEVATION.
 2. THE AERIAL CONTOURS ILLUSTRATE THE HEIGHT LIMITATIONS WITHIN EACH ZONE.
 3. A SLOPE SUCH AS 40:1 EXPRESSES THE HORIZONTAL DISTANCE OF 40 FEET TO THE VERTICAL DISTANCE OF 1 FOOT.
 4. EXISTING TOPOGRAPHIC SYMBOLS ARE THOSE USED BY THE U.S. GEOLOGICAL SURVEY.



CITY OF WINONA, MINNESOTA
MAX CONRAD FIELD

VICINITY MAP AND GRID MAP

ROBERT J. BOLLANT	CITY ENGINEER
DRAWN BY - J.B.C.	SCALE - 1" = 2000'
FILE NO. - H-99.1	
TRACED BY -	MARCH 13, 1974
JOB NO. - 7401	

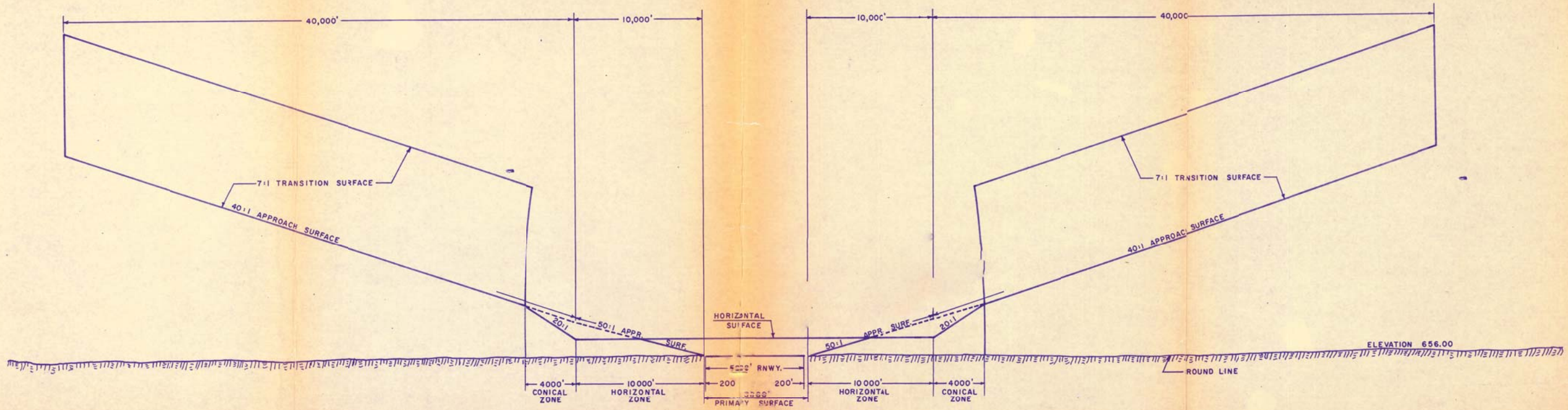

SECTION A-A

SCALE - VER. 1" = 300'
HOR. 1" = 4000'

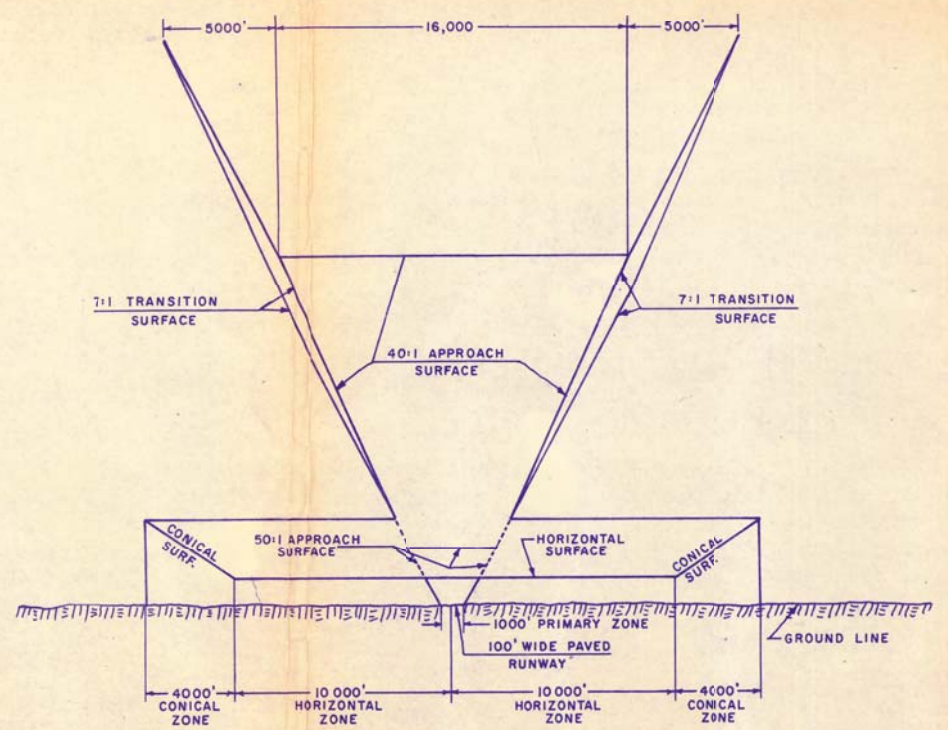

SECTION B-B

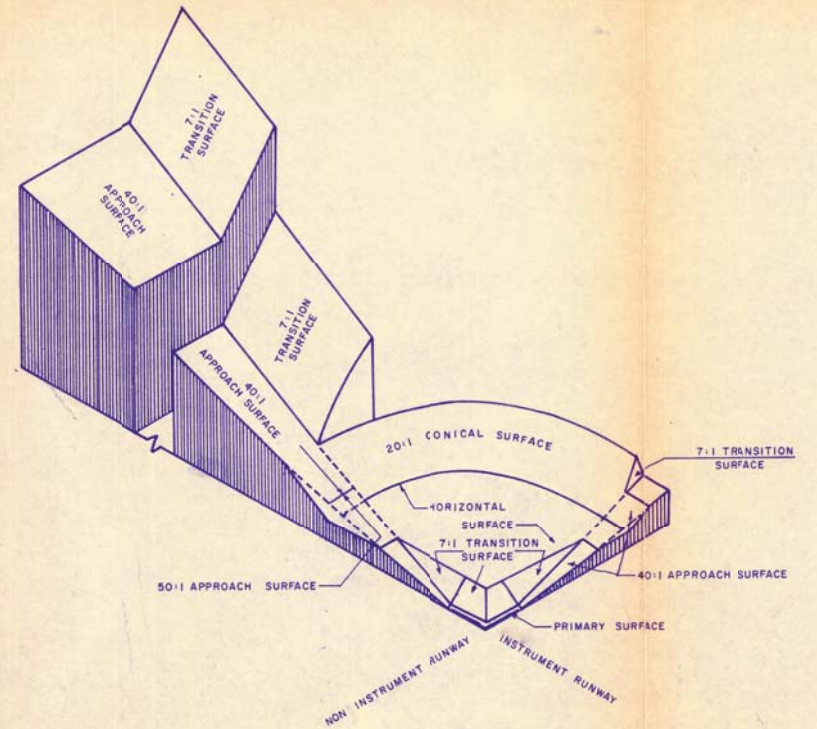

PERSPECTIVE VIEW SHOWING
IMAGINARY SURFACES
NO SCALE

WINONA MUNICIPAL AIRPORT ZONING PLAN
AIRSPACE SECTIONS

CITY OF WINONA, MINNESOTA.		
MAX CONRAD FIELD		
AIRPORT ZONING PLAN		
ROBERT J. BOLLANT	CITY ENGINEER	
DRAWN BY - J.B.C.	SCALE - AS SHOWN	FILE NO. - H-99.3
TRACED BY -	MARCH 13, 1974	JOB NO. - 7401